

# City View



**EUROOAK**

## City View Collection

**Water Resistant Laminate**

**AC4**

**UNILIN** <sup>®</sup>  
PATENTED TECHNOLOGY



**25 YEARS  
residential  
WARRANTY**

**15 YEARS  
light commercial  
WARRANTY**



# INSTALLATION & MAINTENANCE INSTRUCTIONS

## PLEASE READ ALL INSTRUCTIONS CAREFULLY BEFORE YOU BEGIN INSTALLATION. IMPROPER INSTALLATION WILL VOID WARRANTY

- Always check panels for defects such as chips and colour or sheen differences under good light conditions. Also check that the channel is clean and free of debris. Always work out of multiple boxes to mix product to achieve proper pattern repeat.
- Your waterproof flooring MUST be allowed to acclimate to the environment of the installation area. Leave the closed packages in a horizontal position in the room for 48 hours prior to installation. Preferable temperature should be approximately 17-23 C(62-73 F) with a relative humidity of 45-60 percent. Humidity should never be allowed to drop below 30% as this may cause gapping.
- If existing baseboard moldings are difficult to remove, they may be left in place. Quarter round molding is all that is needed to cover the expansion space between.

## TOOLS AND SUPPLIES REQUIRED ARE

- Foam underlay, pressure sensitive polypropylene adhesive tape such as Tuck Tape or equivalent, spacers, tapping block, pull bar, saw, hammer, utility knife, pencil, tape measure, ruler, construction adhesive.
- If installing over a crawlspace or on a concrete floor, you must also install a 4 mil(or thicker) polyethylene vapor barrier under your foam underlay or use a convenient 2 in 1 foam underlay that has a vapor barrier built-in. When installing 2 in 1 foam underlay, butt seams and then completely seal seams using Tuck Tape.

## SUITABLE TYPES OF SUBFLOORS AND FLOOR PREPARATION

- The underfloor or subfloor must be thoroughly even, dry, clean and solid. Carpet staples or glue residue must be removed and floor must be clean to ensure proper installation.
- To check for evenness, hammer a nail into the center of the floor. Tie a string to the nail and push the knot against the floor. Pull the string tight to the farthest corner of the room and examine the floor at eye level for any gaps between the larger than 3mm (1/8"). Any floor unevenness of more than 3mm (1/8") per 1 (3'2"metre must be sanded down or filled in with an appropriate filler.
- Floors must be carefully checked for moisture problems. Any moisture problems need to be solved before installation. New concrete needs to cure for at least 60 days before installation.

• This product is not suitable for damp rooms such as bathrooms, saunas, rooms with damp concrete, rooms with floor drains or rooms that could potentially flood.

• For installation on concrete floors or any floors over a crawl space a vapor barrier MUST be laid down first. Use 4 mil poly. Run the poly 5cm (2") up walls and overlap seams 45cm(18"). Tape seams.

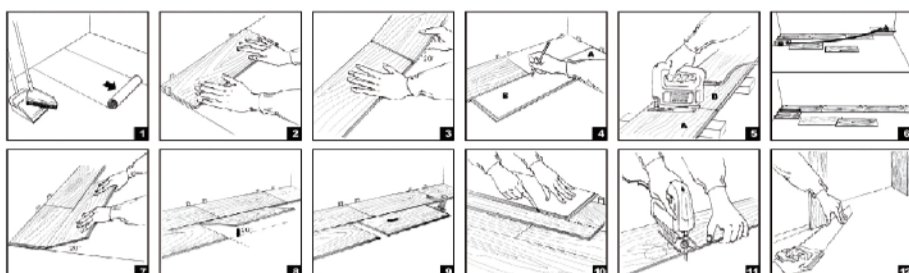

## BASIC INSTALLATION

- All flooring installations require foam underlay. Run the foam underlay in the same direction as the laminate panels. Underlay should be butted side by side with no overlap. Tape seams together. Diagram 1.
- You will need to remove the tongue on the side of the panels that face the wall. This is to ensure that the decorative surface of the laminate floor is well under the finished trim when installed. Use a utility knife to score through the tongue several times until it easily snaps off.
- Start in a corner by placing the first panel with its trimmed side facing the wall. Use spacers along each wall to maintain an expansion space of 8-12mm (5/16"-3/8") between the wall and the flooring. Diagram 2.

## Remember that this product is primarily wood and needs room to expand and contract. At no point should you attach the floor to any surface.

- To attach your second panel, insert the end tongue of the panel into the end groove of the first panel at a 45 degree angle. Lower the panel flat to the floor. Line up edges carefully. Diagram 3.
- Continue connecting the first row until you reach the last full panel. Fit the last panel by rotating the panel 180 degrees with the pattern side upward, place beside row, mark and saw off excess. Attach as described above. Diagram 4.
- When using a handsaw cut on the decorative surface. If you use a jig or circular saw cut with the decorative side down to avoid chipping. Diagram 5.
- Begin the next row with the off cut piece from the previous row to stagger the pattern. Pieces should be a minimum of 20cm (8") long and joint offset should be at least 40cm(16"). Diagram 6.
- To start your second row, Push the side tongue of the panel into the side groove of the very first panel at about 45 degrees. When lowered, the plank will click into place. Diagram 7.
- Attach the second panel of the new row on the long side as described above. Push this panel as close as possible to the previous row. To attach this second panel to the previous panel, tap the end using a tapping block and rubber mallet. Continue along in the same fashion. Diagram 8/9.
- To fit the last row, lay a panel on top of the previous row. With the tongue to the wall, lay another panel upside down on the one to be measured and use it as a ruler. Don't forget to allow room for spacers. Cut the panel and attach into position. Diagram 10.
- Door frames and heating vents also require expansion room. First cut the panel to the correct length. Then place the cut panel next to its actual position and use a ruler to measure the areas to be cut out and mark them. Cut out the marked points allowing the necessary expansion distance on each side. Diagram 11.
- You can trim door frames by turning a panel upside down and using a handsaw to cut away the necessary height so that panels slide easily under the frames. Diagram 12.
- Remove spacers and you are ready to install finishing molding.



T-Molding  
Moldura en T



Reducer  
Reductor



Stair Nose  
Nariz de escalera



Quarter Round  
Cuarto dosel



End-Molding  
Moldura de terminación

## FINISHING MOLDING

- Reducer molding is used to finish flooring when the adjoining surface is lower than the waterproof flooring or when flooring meets carpet. Position the U track 7mm(1.4") between each edge of the flooring. Screw, nail or glue down the track directly to the subfloor and then insert the reducing strip into the track.
- T-molding is used to finish flooring when two level surfaces meet in doorways or for expansion joints. Install same as above. If your room is more than 7m (23') wide you will need to allow for an expansion joint. Expansion joints use T-molding and can be positioned in any inconspicuous place.
- Landing molding is used to finish flooring on landings or stair edges. Moldings need to be glued and screwed down to the sub-floor for safety and stability. Color fill should be used to cover counter sunk screws.
- To finish the perimeter of the room install quarter round molding using finishing nails. Quarter round molding is nailed directly into the baseboard.

## CARE AND MAINTENANCE

- 25 Year Residential Water Resistant Laminate Warranty  
The manufacturer warrants to the original purchaser that the flooring will be free of manufacturing defects, and the surface will not wear through\*, stain or fade from sunlight or artificial light when used under normal residential traffic conditions. \*Wear-through is defined as total loss of pattern in a minimum of 2 square inch area. Scratches and loss of gloss are not considered as wear-through. If the product wears through, stains or fades, we will at its option replace or refund the portion of the floor in question as covered under this warranty. This warranty does not cover labor, nor any other incidental expenses incurred as a result of covered defect. Should the original floor be discontinued, we will replace the defective material with a floor of equal value. This warranty is exclusive to the original purchaser and in lieu of all other warranties, expressed or implied, and all other remedies, guarantees or liabilities arising by law or otherwise.
- 15 Year Commercial Water Resistant Laminate Warranty  
The manufacturer warrants to the original purchaser that the flooring will be free of manufacturing defects, and the surface will not wear through\*, stain or fade from sunlight or artificial light for 15 years after the date of purchase of the product when used under normal commercial traffic conditions. \*Wear-through is defined as total loss of pattern in a minimum of 2 square inch area. Scratches and loss of gloss are not considered as wear-through. Heavier traffic areas such as entry ways, food preparation areas such as commercial kitchens, and any areas with heavy rolling loads are not recommended. If the product wears through, stains or fades, we will at its option replace or refund the portion of the floor in question as covered under this warranty. This warranty does not cover labor nor any other incidental expenses incurred as a result of covered defect. Should the original floor be discontinued, we will replace the defective material with a floor of equal value. This warranty is exclusive to the original purchaser and in lieu of all other warranties, expressed or implied, and all other remedies, guarantees or liabilities arising by law or otherwise.

## Terms and Conditions for Water Resistant Laminate Warranty

- The Laminate Flooring panels must be properly installed in accordance with laminate flooring installation instructions, and must be used for indoor use only.
- This warranty does not cover negligence, improper installation/maintenance, insufficient protection, improper alterations to the original materials, insects, severe accidents, exposure to extreme heat, burns, fire, natural disasters.
- The floor must be properly maintained to consider a claim. Improper maintenance can damage your floor. Sweep the floor on a regular basis, at least once per week, if you use a vacuum cleaner the beater bar must be turned off. The beater bar will damage your floor. No Wet Mopping. We recommend using Bona laminate floor cleaner by spraying it on the mop head not directly on the floor. Never use a wax based product on your floor.
- Floors installed in bathrooms or saunas are not covered under warranty
- This warranty does not cover transition accessories or moldings
- This warranty only applies to 1st quality product purchases made after the edition date of these warranty conditions for the designated time period when the product is installed in a private residence.
- Laminate flooring panels must be inspected prior to installation under sufficient lighting. Products with visible defects must never be installed under any circumstance. Laminate flooring panels installed with any manufacturing defect are not covered by this warranty. Any defect must be reported prior to installation and within 30 days of purchase in order to be covered. Color or gloss issues as a result of adding material at a later date from non-warranty repairs are excluded from coverage.
- This Warranty is non-transferable and only applies to the original end consumer.
- This product warranty only applies to defects inherent to the material supplied. This means any material or production defects, acknowledged by the manufacturer. It includes the delaminating or reduced resistance of the wear layer. The manufacturer will repair or replace the product, at its option. When replacement of the flooring is made, only new panels from the current product range at the time the complaint is upheld will be supplied by the distributor or retailer. There will be no other form of compensation.
- This warranty does not apply to laminate flooring that has been put to abnormal use or conditions or abused in any way. Abnormal use or conditions includes, but is not limited to, water damage from plumbing, storm or flood, damage from smoke, fire or other casualty events; damage caused by negligence, improper alterations of the original manufactured product. Abuse is any use of the flooring that is unreasonable considering the normal and expected uses of a laminate floor in a residential environment. The damage to the product must be evident, measuring the size of a dime and must not be the result of abusive, abnormal conditions or accidents, such as but not limited to, damage of mechanical nature, severe impact or scratches (caused by dragging objects or furniture) or cutting. The feet of furniture must always be covered with appropriate protective material. Chairs, sofas or furniture with castors must be fitted with soft rubber wheels, an adequate protective mat or protective castor cups must be put under this furniture.
- This warranty does not apply to damage from extreme heat, dryness, moisture of any kind other than regular cleaning as has been explained in this warranty. You must maintain the temperature 65F to 85F and humidity 35% to 55% in your home. Fluctuations in temperature or humidity can damage your floor.
- This warranty excludes damages caused by water, included but not limited to appliance and plumbing failures, natural disaster such as floods, urine, or any standing water.
- This warranty excludes damages caused by water or moisture trapped beneath the floor due to an improper sub floor or underlayment without a moisture barrier.
- We will not be responsible for any loss of time, inconvenience expenses, costs or consequential damages caused by or resulting directly or indirectly from a problem about which the claim was made.

## MAINTENANCE

- Never use wax, polish, oils, soaps, detergents, shine enhancers, or varnish on the floor.
- For dry maintenance, we recommend a dust mop or vacuum cleaner with soft bristle brush only.
- For slightly damp maintenance, we recommend a laminate cleaner which you spray directly and lightly on a duster. Always wipe dry immediately until no more moisture is visible on the floor. The use of other cleaning products might damage your floor. For bevel edge products, we strongly recommend dry cleaning only.
- Do not use any type of cleaning machine such as spray mops, steam cleaners/ mops or power cleaners.
- Wet maintenance is absolutely forbidden. Remove any water immediately. Our laminates are not suitable for use in damp spaces like saunas.
- Remove stubborn stains carefully with acetone based fingernail polish remover. Never use scouring products!
- In case your floor needs repair, the planks can easily be removed in minutes without replacing the entire floor. The required expansion gap must be in place around the room's perimeter and extra flooring should be available for use in the repair. Enjoy your floor.

**In any environment, leave a concealed 3/8" minimum expansion space on all sides of the floor, including pipes, thresholds, doorways, and any fixed /stationary objects (door vents, kitchen islands, etc.).**

**NOTE: The subfloor must be level and flat per the specification and tolerance stated. High spots must be ground down and low spots must be filled with a Portland cement leveling compound.**

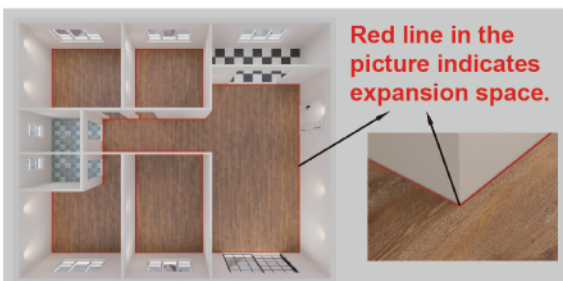

Red line in the picture indicates expansion space.